

Whelans Precast



Concrete Built is Better Built

Whelans Precast is a wholly owned subsidiary of the Whelans Group of companies founded by Patrick Whelan in 1972. The Whelan Group has developed into the largest independent supplier of quarry products, readymix, precast concrete and bitumen products in the Republic of Ireland. Our precast products are manufactured in an enclosed factory environment at our Quarry based in Ennis, Co.Clare. We have a current capability of producing 700m² of flooring and 5 precast stairs per day. Manufacture is continually supervised by our in house quality control department to ensure all our products meet the requirements of BS8110 – The Structural use of Concrete.



Precast Flooring



Precast Production



Precast Stairs

Advantages of Precast Flooring & Stairs

1. No Creaking Floors
2. Provides immediate working platform
3. Sound insulation
4. Excellent fire resistance
5. Durable and vermin free
6. Speed of installation (3 hrs / dwelling)
7. Technical Support provided
8. Thermally Efficient

Procedure for Order, Manufacture & Delivery of precast floors

1. Send a copy of your house plans together with full address and contact details.
2. Quotation will be sent with precast flooring information.
3. Upon receipt of written acceptance of quotation, an approximate delivery date will be agreed.
4. Two weeks before delivery date, a Whelans Engineer will call to site to measure constructed block work and prepare slab layout plans.
5. Completed slab layout plans will be sent for approval.
6. Upon approval, slabs/stairs will be manufactured, delivered and placed as per agreed delivery date.

WHAT FLOOR DO I REQUIRE?

1. Please select which option below suits your requirements.
2. Check from your plans to see what is your longest span distance.
3. Use table under your option to indicate what precast flooring product will be suitable.
4. This is for a guide only and Whelans Precast will carry out all necessary design calculations.

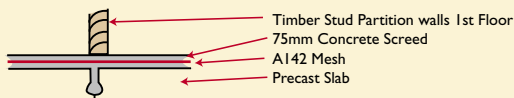

Option One

Maximum Span (meter)	4	5	6	7	8
Precast slab required	100mm Wideslab	100mm Wideslab	100mm Wideslab	100mm Wideslab	150mm Wideslab

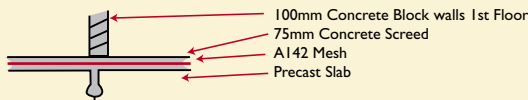

Option Two

Maximum Span (meter)	4	5	6	7	8
Precast slab required	100mm Wideslab	100mm Wideslab	100mm Wideslab	125mm Wideslab	150mm Wideslab

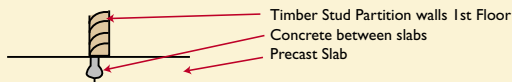

Option Three

Maximum Span (meter)	4	5	6	7	8
Precast slab required	100mm Wideslab	100mm Wideslab	125mm Wideslab	150mm Wideslab	150mm Hollowcore

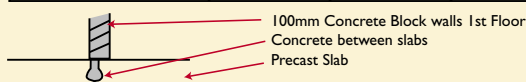

Option Four

Maximum Span (meter)	4	5	6	7	8
Precast slab required	100mm Wideslab	125mm Wideslab	150mm Wideslab	150mm Hollowcore	200mm Hollowcore

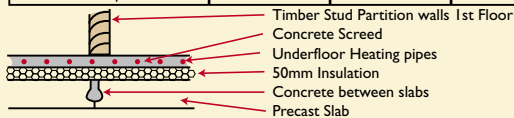

Option Five

Maximum Span (meter)	4	5	6	7	8
Precast slab required	100mm Wideslab	125mm Wideslab	150mm Wideslab	150mm Hollowcore	200mm Hollowcore

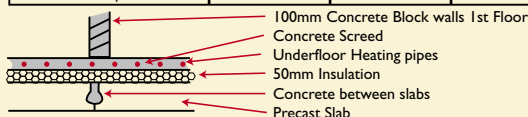

Option Six

Maximum Span (meter)	4	5	6	7	8
Precast slab required	100mm Wideslab	125mm Wideslab	150mm Wideslab	200mm Hollowcore	250mm Hollowcore

General Notes

1. Slabs must be installed by competent contractors.
2. Slabs must be propped until 5-7 days after screed is poured.
3. Floors must not be subject to any loads until props are in place.
4. Joints between slabs to be filled with concrete.
5. Canterlever slabs must have minimum 75mm screed.
6. No alterations to be made to precast slabs without prior agreement from Whelans.

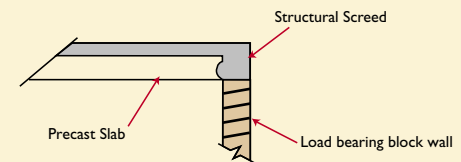

SECTION THROUGH SIDE OF PRE-CAST

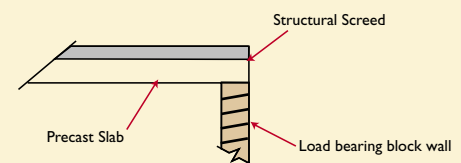

SECTION THROUGH END OF PRE-CAST

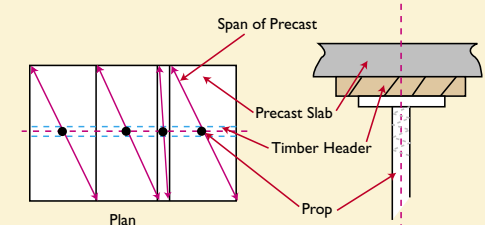

TYPICAL PROPPING DETAIL

300MM X 50MM TIMBER HEADER CENTERED ON SLABS

WHELANS PRECAST

Fountain Cross, Ennis
County Clare, Ireland.

Tel: +353 (0) 65. 6862954 Fax: +353 (0) 65. 6862940
Email: precast@whelansgroup.com Website: www.whelansgroup.com

